

Detail A
Scale: 1" = 10'

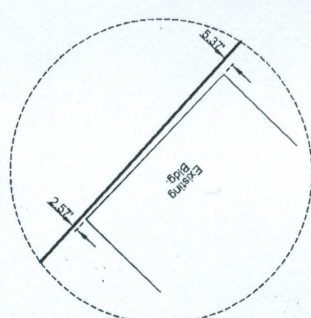

Detail B
Scale: 1" = 10'

Containing 238860.36 Square Feet or 5.44 Acres.
Subject to all easements and restrictions of record.

Christy Lane Development, Inc.
George Pate, President

ATTEST

Notes:

- 1.) Reference Bearing from Plat by Bryan and Associates, Inc.
- 2.) Bearing and Dimensions in Parenthesis from Plat of Record, Deeds of Record and previous Survey.
- 3.) Book and Page Numbers refer to the records of Cole County, MO.
- 4.) (Tract 1) transferred to Christy Lane Development, Inc. L.L.C. Book 512, Page 977. (Tract 2) transferred to M.O.D.O.T., Book 512, Page 978. (Tract 3) transferred to Christy Lane Development, Inc. L.L.C., Book 512, Page 977. All Tracts Based upon a Survey of Record in Book A, Page 880, Cole County Recorder's Office.
- 5.) Survey based on Deed recorded in Book 400, Page 930 of the Records of Cole County, MO.
- 6.) The tract of and shown by the city and plat is zoned C-2 per City of Jefferson, MO; Zoning Ordinance.
- 7.) All Lots will be Subject to Proposed Joint Easements as provided in the Declaration of Joint Driveway, Parking, and Pedestrian Easements to be Recorded hereafter in the Records of Cole County, MO.

Utilities Provider

- Water Service - Missouri American
- Sanitary Sewer - City of Jefferson, MO
- Electric - Ameren U.E.
- Natural Gas - Ameren U.E.
- Telephone - Sprint
- Storm Sewer - City of Jefferson, MO
- Cable Television - Media Com

Broadmoor Country Club and Apartments of Jefferson City
Book 253
Page 017

Seville Properties
Book 265
Page 251

Spring Valley Subdivision Plat
Book 005
Page 035

Scruggs Gableman Lumber Company
Book 241
Page 165

Lot 1
48873.00 Sq. Ft.
1.12 Acres

Lot 2
66217.00 Sq. Ft.
1.57 Acres

Lot 3
20000.00 Sq. Ft.
0.46 Acres

Lot 4
115485.00 Sq. Ft.
2.65 Acres